

9.2

VISUALLY INTELLIGENT SOLUTIONS Real-time Safety and Security Solutions www.digitalbarriers.com

REAL-TIME ELEVATED TEMPERATURE DETECTION

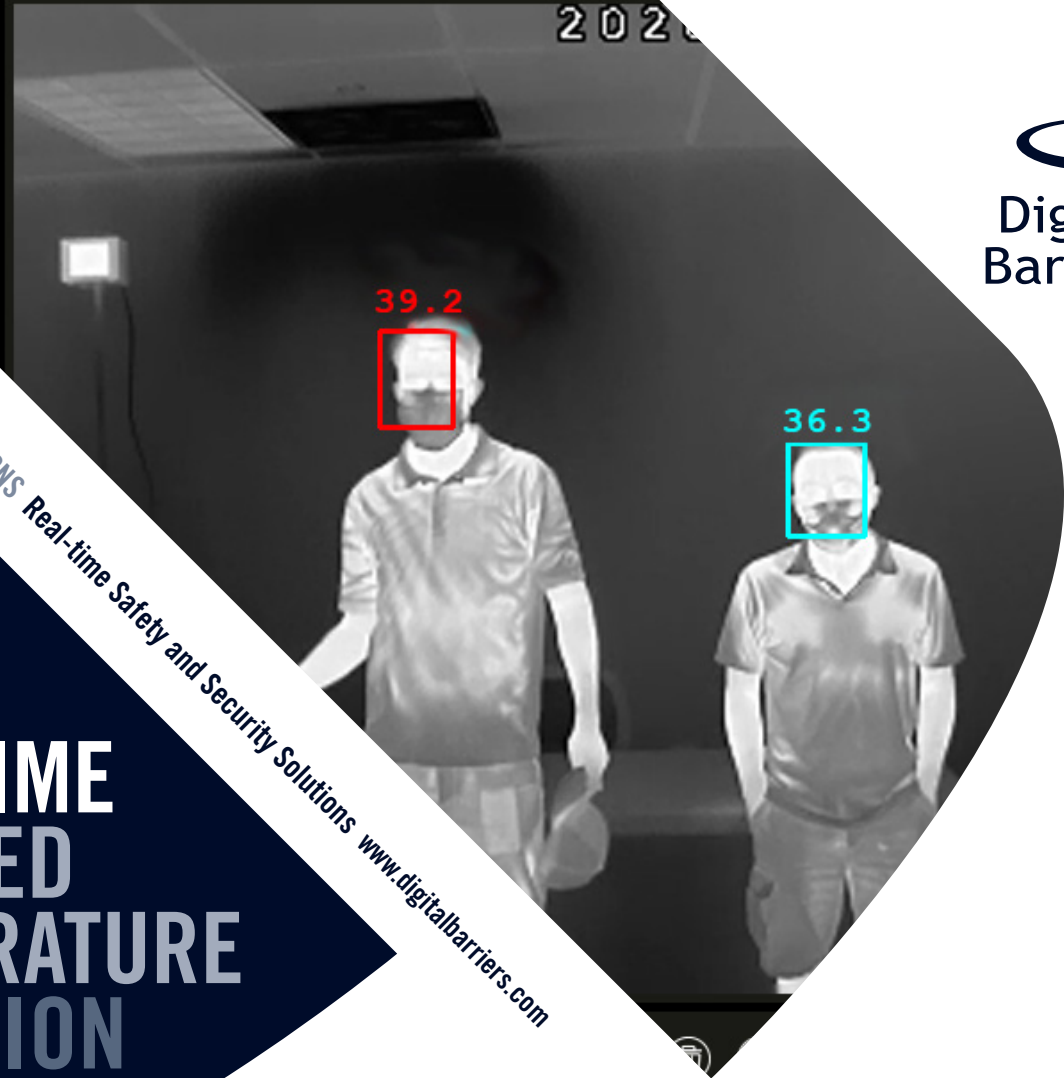

Elevated Temperature Screening Solution

Temperature detection and profiling systems have emerged as an important tool in uncovering Elevated Body Temperature (EBT), a key indicator of the presence of illness, thereby potentially exposing an underlying health condition.

Without a rapid diagnostic tool, thermal camera screening can provide workplaces and public spaces such as hospitals, commercial properties and transportation hubs with a highly effective means of detecting individuals during outbreaks. Such technology has now become critical for early identification and the prevention of further transmission, whilst also safeguarding both staff and customers.

By combining EdgeVis Live, Digital Barriers' unique video streaming capability with a thermal and HD camera, users have a perfect standoff elevated temperature detection solution, ideal for remote locations and when limiting human contact is essential.

The thermal devices provide HD images as well as local and remote alarms, that can be triggered when a specific temperature threshold is exceeded.

The thermal and HD camera can be deployed as a standalone system or as part of a networked solution, feeding back to a centralised command and control location or mobile device.



Thermal HD camera features:

- High accuracy (0.3C)
- High resolution 384 x 288 image
- SDK support
- HD visible camera with PiP display
- IP65 rated
- Custom colours available
- Paired blackbody for temperature reference
- Screens up to 100 people in 60 seconds
- Up to 8 people in FOV at once

EDGE VIS™ Live

EdgeVis Live is the world's most flexible end-to-end surveillance distribution platform. It features a unique approach to video encoding and transmission to deliver a resilient stream of usable video from operators in the field, over almost any wireless network.



Complete network control with access to full-res images and video

EdgeVis Live offers great flexibility and control for mobile units and central command. Even when viewing remote video feeds on a mobile device, an operator is able to access HD images or PTZ the camera at source. As well as viewing real-time surveillance, a user is able to access footage recorded at the edge remotely and securely.

Unlimited and secure redistribution of live video across Cellular/Wi-Fi networks for a joined up intelligence-led response.

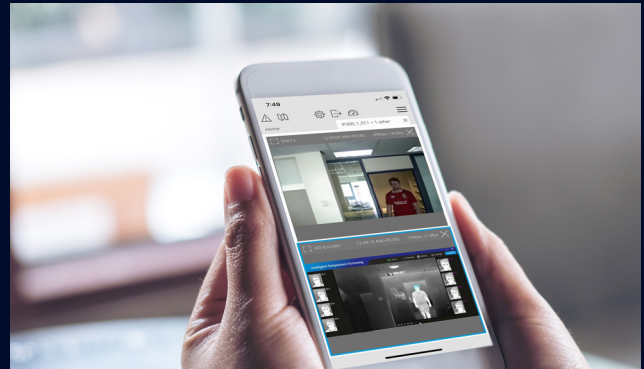

Delivering live video from anywhere to anywhere

EdgeVis Live is designed for mobile real-time video streaming, addressing variability in networks and high levels of scene motion, that can render conventional solutions unusable. Active network adaptation ensures video never exceeds available bandwidth, maintaining a constant frame rate without latency image break-up.

Our solutions have the unique ability to transmit usable surveillance on almost any network from almost any source.

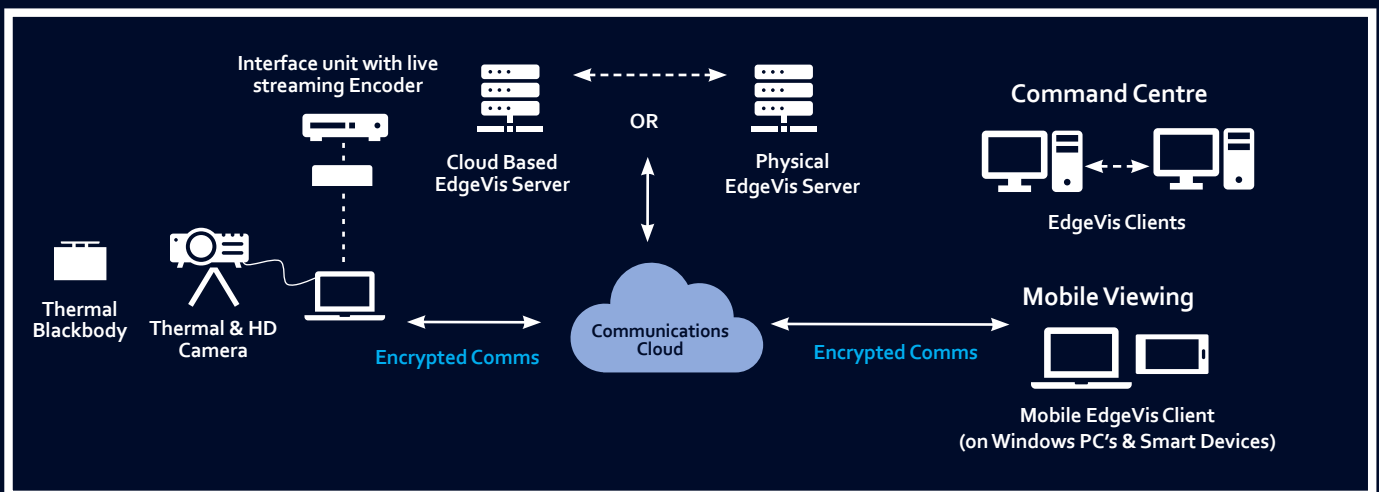

TECHNICAL SPECIFICATIONS

GENERAL	Lens	7.8mm	IMAGE PRESENTATION	Video Output	IP RTSP / SDK Integration
	Detector	VOx uncooled thermal FPA		Video over IP	H.264 RSTP and ONIVF Profile-S
	Resolution	384 x 288	TELEMETRY	Protocols	ONVIF Profile-S
	Field of View	47.0° (H) 35.6° (V)		Interface	ONVIF Profile, Serial <> IP
	Pixel Size	17µm	PHYSICAL CHARACTERISTICS PRESENTATION	Part Number	RCF
	Frequency	50Hz		Input Voltage	Nominal 24VDC
	Measurement Range	1 - 5m		Power Consumption	Typical: 53W, Peak:100W
THERMAL IMAGE	Image Adjustments	Brightness, Contrast. Manual/Auto		Housing Material	Iridited aluminium, White powder marine grade paint finish (other colours available upon request)
	Polarity	Black Hot / White Hot		Camera Weight	5kg / 12.2lb
	Palette	18 palettes		Camera Size (mm)	H90 x W134 x D145
	Digital Zoom	8x Continuous Digital Zoom (0.1x step size)	INTERFACES	Ethernet	Command and control of all functions including streaming of H.264 Video
	Image Process Time	NUC / DDE / Digital Filtering Noise Reduction		RS485	Command and control of all functions and Firmware Upgrade
	Image Flip	Left-Right / Up-Down / Diagonal	ENVIRONMENTAL	IP Rating	IP65
	ROI	Yes		Temperature Range	-30°C (-22°F) up to 65°C (149°F) (-40°C with optional heater)
TEMPERATURE MEASUREMENT	Measurement Range	0°C - 60°C	BLACKBODY	Voltage Input	180-240VAC
	Measurement Accuracy	±0.5°C at 33°C - 42°C of target temperature (±0.3°C with blackbody)		Power	260W Peak
	Working Temperature	16-32°C (with 0.3°C accuracy with blackbody)		Working Temperature	5-100°C
	Measurement Tools	10 customized spots, highest/lowest spot, full frame temperature data, central spot, 12 lines/areas, isotherm	Time to Stabilise	<5 minutes	
	Measurement Stable Time	≤10s (fastest)	MINIMUM PC/LAPTOP HARDWARE SPECIFICATION	CPU	I5 (or equivalent)*
	Temperature Correction	Manual / Auto Correction		RAM	8GB
VISIBLE CAMERA	Focal Length	8mm Fixed lens		Operating System	Windows 10
	Image Sensor	1/2.8" CMOS (2.13MP)		Monitor Resolution	HD
	Resolution	1920 x 1080 (Full HD)		Hard Drive	Minimum 256G
	Horizontal FOV	39°	KIT CONTENTS	Dual head HD/Thermal sensor with stand or Tripod	
	Focus	Fixed		Blackbody reference with Tripod	
	Minimum Sensitivity	0.1 lux		Cable – 5m	
	PiP Display	Supported		Monitoring Laptop	
	Other Features	De-Fog, WDR, Digital Noise Reduction	Interface enclosure containing video streaming equipment and power distribution		

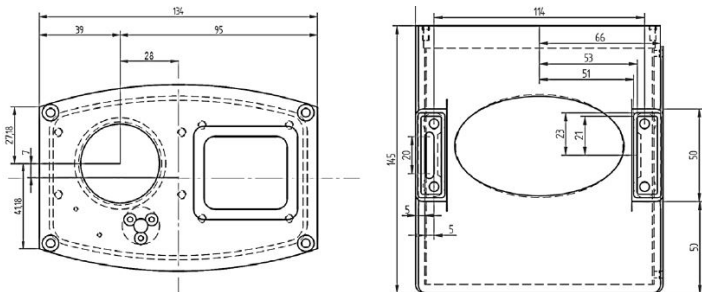

Mechanical Drawings

*Or CPU Benchmark >7500

Contact Digital Barriers or your local reseller for further details on our solutions

DB007 v.1.10| E&OE. Specifications subject to change without notice.
©2020 Digital Barriers. All rights reserved.

Digital Barriers

www.digitalbarriers.com